

## RISC005B – RISC006B

Replacement scheme		
Need replacement after each use		Need replacement if contaminated or damaged
800 ml canister (RISC005B)	1000 ml canister (RISC005B)	Serres Canister (RISC006B)

### RISC005B Components

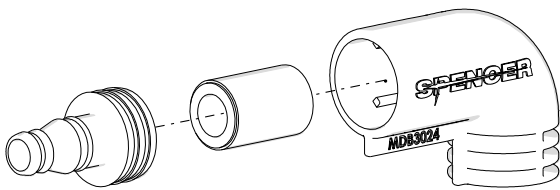

### RISC006B Components

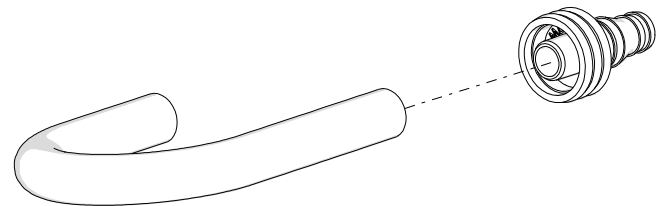

### RISC005B Assembly

(needed only if during transport or assembling, components separation has occurred)

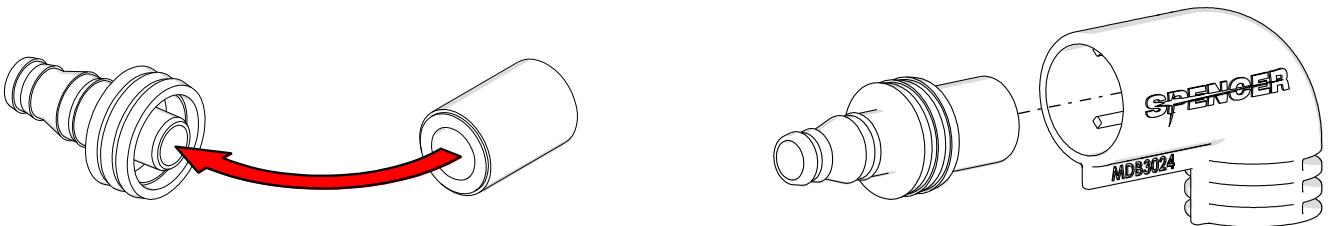

### 800 ml Canister installation

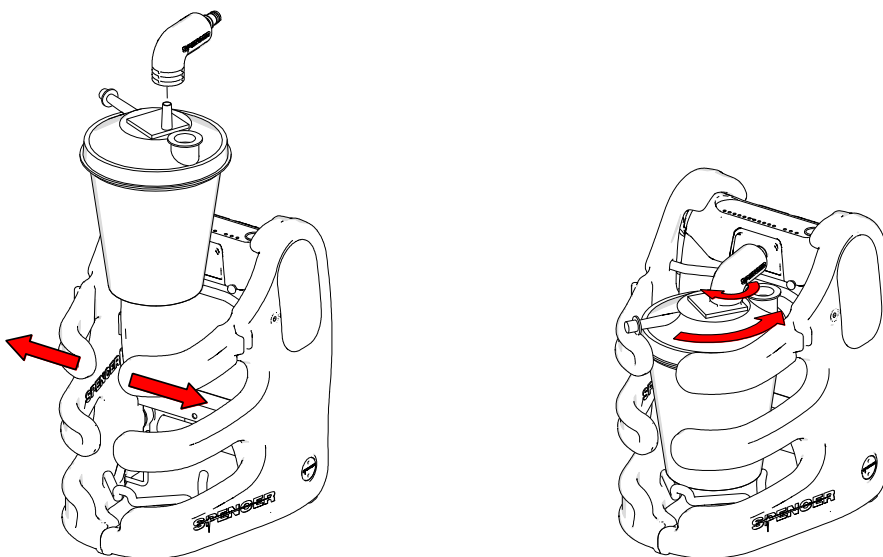

**Warning: Don't press the filter when turning it for insertion in the suction unit  
Damage may occur**

### 1000 ml Canister installation

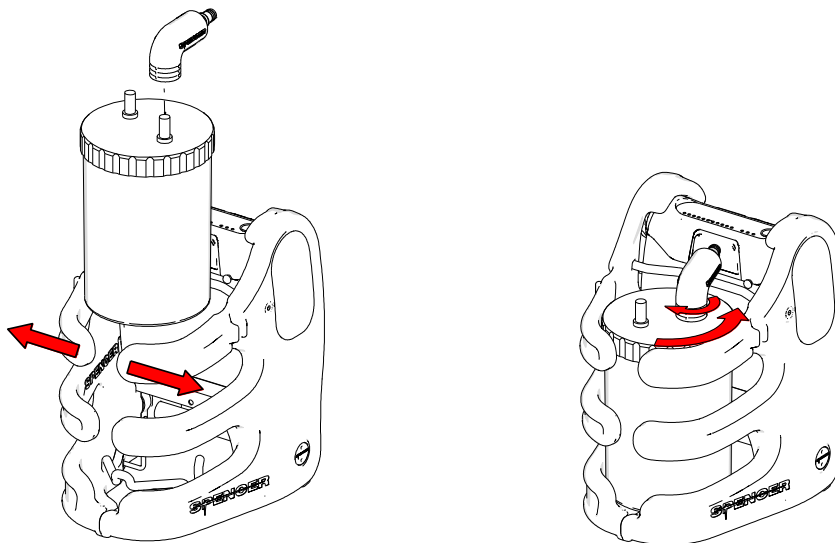

Warning: Don't press the filter when turning it for insertion in the suction unit  
**Damage may occur**

### Serres Canister installation

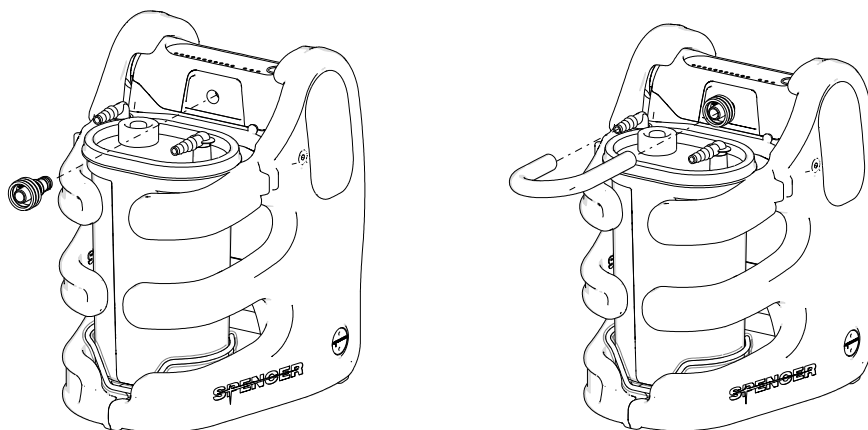

*Per l'uso corretto del dispositivo e per le necessarie verifiche funzionali, fare riferimento al manuale d'uso di Home Jet o Ambu Jet consultabili [QUI](#)  
 For a proper use of the device and functional test to be carried, refer to the user manual of Home Jet or Ambu Jet [HERE](#)*

Rev.0 (22/06/2015)

COPIA NON CONTROLLATA – successive revisioni saranno disponibili al link <http://support.spencer.it>  
 Spencer Italia S.r.l. Collecchio (PR) Italia Tel. +39.0521.541111 Fax +39.0521.541222  
[www.spencer.it](http://www.spencer.it)

© Diritto d'autore - Questo documento è di proprietà di SPENCER ITALIA SRL e non può essere riprodotto, utilizzato e divulgato senza autorizzazione scritta da parte di SPENCER ITALIA SRL.  
 © Copyright - This document is property of SPENCER ITALIA SRL and can't be reproduced, used and disclosed without the written approval of SPENCER ITALIA SRL